

I ILLINOIS**McKechnie Family LIFE Home****COLLEGE OF APPLIED HEALTH SCIENCES*****Living in Interactive Future Environments***

The McKechnie Family LIFE Home is a cutting-edge research center focused on innovations in home environments. This facility mimics existing home dwellings (i.e., typical home of today) as well as provides space for the development of next generation smart homes (i.e., house of tomorrow) that would allow people of all ages and abilities to live fuller, healthier, and autonomous lives. Spaces include a two-bedroom home; an attached garage; multi-purpose research and collaboration rooms; outdoor areas; and capacity for community engagement. Research and development efforts focus on a range of topics related to in-home activities to improve quality of life and independence.

Engagement Benefits

The research and development efforts performed in this facility focus on developing and testing new technologies to support independent living, healthcare needs, social interaction, and everyday activities. The Observation & Control Center enables viewing and recording interactions in the home simulation space. The laboratory spaces provide opportunities for rapid prototyping of technologies, participant interviews, remote presence research, and educational and training activities. The collaborative spaces provide a hub for research teams, industry partners, clinicians, and for community engagement.

Research Opportunities

This facility is an interdisciplinary campus hub for activities related to technologies for health, independence, and quality of life including:



In-home Sensors



Wearables



Human Computer Interfaces



Telehealth



Communication Technologies



Assistive Devices



Indoor Climate Technologies



Smart Appliances



Rehabilitation



Robotics

Wendy A. Rogers, PhD
Director
wendyr@illinois.edu

Harshal Mahajan, PhD
Assistant Director of Research
mahajan6@illinois.edu

Brian Pastor, MS
Operations Manager
pastor2@illinois.edu



**College of Applied
Health Sciences**
UNIVERSITY OF ILLINOIS URBANA-CHAMPAIGN

in collaboration with



**Grainger College
of Engineering**
UNIVERSITY OF ILLINOIS URBANA-CHAMPAIGN

OUTDOOR SEATING

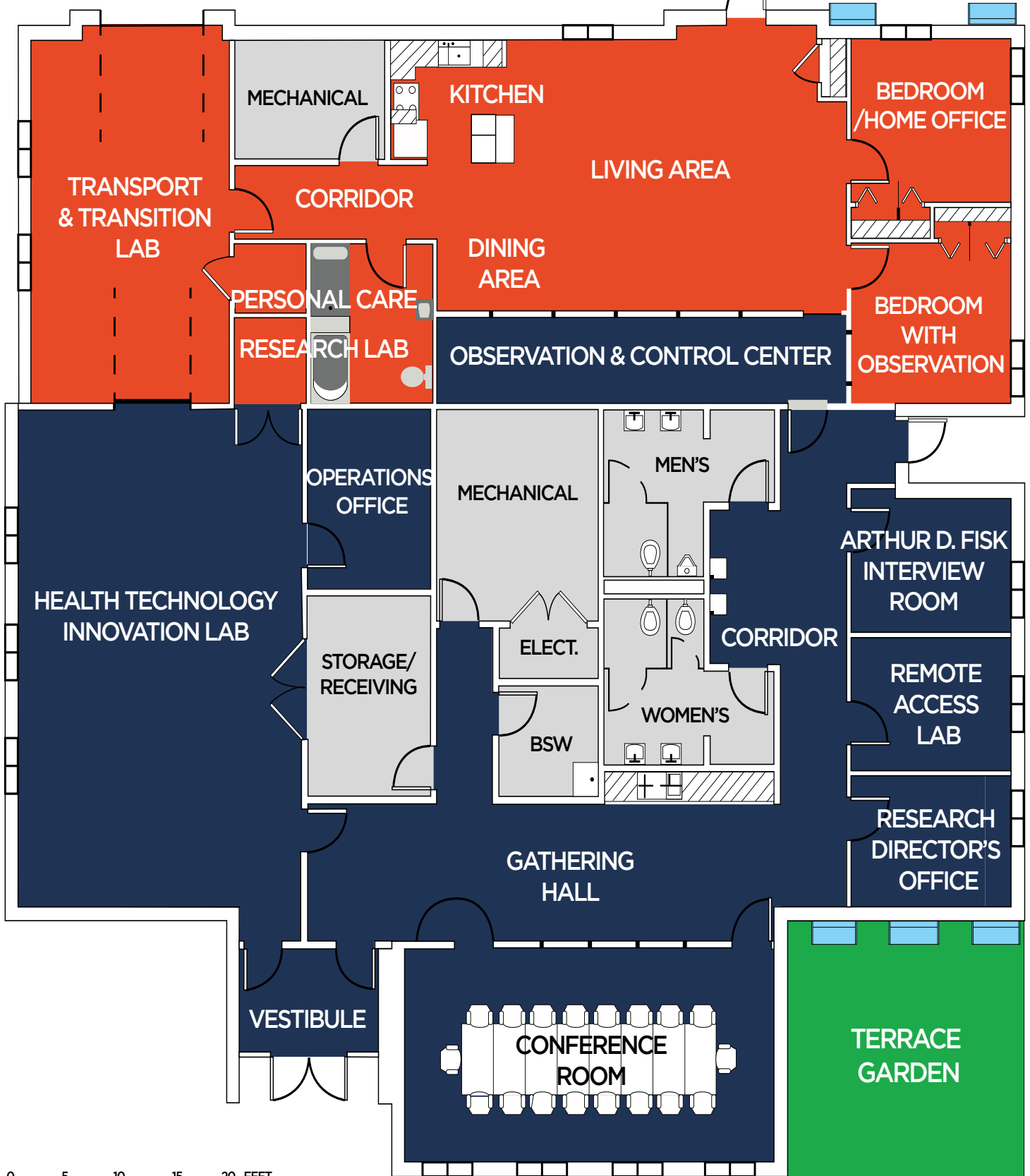

0 5 10 15 20 FEET



Home Simulation



Collaborative Space



Service